

Flytrap Industrial ATEX

Specialist Glueboard Insect Control

Please read these instructions carefully and store in a safe place for future reference.

FLYTRAP COMMERCIAL

As part of the P+L brand of insect control products, **Flytrap Industrial ATEX** is a heavy duty industrial glueboard flying insect control unit certified to  II 3 D for use in areas where the potential for explosions exist. **Flytrap Industrial ATEX** utilises highly effective shatterproof UV tubes and is designed for use with a high specification glupac™ glueboard. **Flytrap Industrial ATEX** is available as a 40W wall mounted product or 80W ceiling suspended version.

Contents of package

- 1 x Flytrap Industrial ATEX flykiller

FTI 40 ATEX

- 1 x glupac™ pheromone impregnated glueboard
- 2 x High powered shatterproof UV tubes (Fitted)

FTI 80 ATEX

- 2 x glupac™ pheromone impregnated glueboards
- 4 x High powered shatterproof UV tubes (Fitted)

WARNING - THIS APPLIANCE MUST BE EARTHED

INSECT CONTROL PRODUCTS

Flytrap Industrial ATEX utilises high powered shatterproof ultra violet tubes to attract flying insects and retains the caught insects on a pheromone impregnated glueboard for inspection or hygienic disposal.

POSITIONING

THIS UNIT IS FOR INDOOR USE ONLY.

Flytrap Industrial ATEX should ideally be fixed at least two meters above the ground, preferably in the darkest place within the area to be protected and is supplied with a two meter mains lead. Do not position the unit close to windows, skylights or other sources of light, or where it may be obscured by furniture, doors or other obstacles. Ideally, **Flytrap Industrial ATEX** units should be visible from every part of the area to be protected.

INSTALLATION

THE MANUFACTURERS OF THIS PRODUCT CAN NOT BE HELD RESPONSIBLE FOR THE SITING OF THE UNIT WITHIN SPECIFIC APPLICATIONS SUCH AS FLOUR MILLS AND IT IS ADVISED YOU CONTACT YOUR LOCAL FIRE AUTHORITY BEFORE INSTALLATION.

PRIOR TO INSTALLATION, ENSURE THE POWER SUPPLY OF YOUR MAINS OUTLET CORRESPONDS TO THAT MARKED ON THE SPECIFICATION LABEL FOUND ON THE FLYKILLER.

Flytrap Industrial ATEX should be installed in position using high specification fixings appropriate for the application. Once installed in position, fit the glupac™ glueboard in position as described in the glueboard replacement section of this document. **Flytrap Industrial ATEX** should be hard wired into an appropriate power source.

WARNING - THIS APPLIANCE MUST BE EARTHED

USING FLYTRAP INDUSTRIAL ATEX

Flytrap Industrial ATEX should ideally be in operation for 24 hours a day, ensuring your premises are kept free of flying insects. Insects are most attracted to **Flytrap Industrial ATEX** unit at night when there is no competition from daylight or other light sources.

CLEANING

ENSURE THAT THE FLYING INSECT KILLER IS DISCONNECTED FROM THE MAINS BEFORE CLEANING

It is recommended that cleaning is carried out regularly when the glueboard is replaced. Once the glueboard is removed, the unit should be thoroughly wiped down with a damp cloth, removing any build up of dirt. Ensure the unit is completely dry before reconnecting it to the power supply.

GUARANTEE

Flytrap Industrial ATEX has a five year guarantee and if maintained as recommended in these instructions should continue to work for many years.* Use of non-approved consumables may invalidate the guarantee. Ensure genuine glupac™ glueboards are used in conjunction with this product.

*Excludes tubes and glueboards. Does not cover breakdown due to misuse, incorrect operation or use in an incorrect application.

Flytrap Industrial ATEX

GLUEBOARD REPLACEMENT

BEFORE REPLACING THE GLUEBOARD, ALWAYS ENSURE THAT THE UNIT IS DISCONNECTED FROM THE MAINS SUPPLY.

The glueboard should be replaced every month with a genuine glupac™ glueboard. Use of non-approved glueboards may invalidate your guarantee.

To replace the glueboard...

1. Remove the outer metal guard by pulling the lock nuts located at the front of the base.
2. Remove the used glupac™ glueboard by pulling it free from the retaining clips and either retain for catch evaluation or dispose of it hygienically.
3. Remove the protective release paper from the new glupac™ glueboard.
4. Slide the new glupac™ glueboard into position with the adhesive side facing the tubes and ensure it is held in position by the retaining clips.

Always ensure the selected genuine glupac™ glueboards are compatible with your unit, available from your PCO or P+L Systems Ltd.

TUBE REPLACEMENT

BEFORE REPLACING THE TUBES, ALWAYS ENSURE THAT THE UNIT IS DISCONNECTED FROM THE MAINS SUPPLY.

To ensure the efficiency of **Flytrap Industrial ATEX** in catching flying insects, the shatterproof UV tubes should be replaced annually. After twelve months the phosphor coating that emits the correct wavelength of UV light has burnt away and the UV output is diminished substantially.

To replace the shatterproof UV tubes...

1. Remove the outer metal guard by pulling the lock nuts located at the front of the base.
2. Unscrew the tube seals and move towards the centre of the tube.
3. Pull the tube away from the unit, freeing it from the tube holders.
3. Dispose of the used UV tube in conjunction with local WEEE regulations.

MOUNTING OPTIONS

WALL MOUNTED

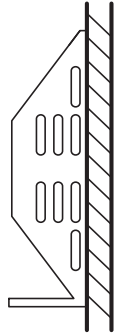

CEILING SUSPENDED

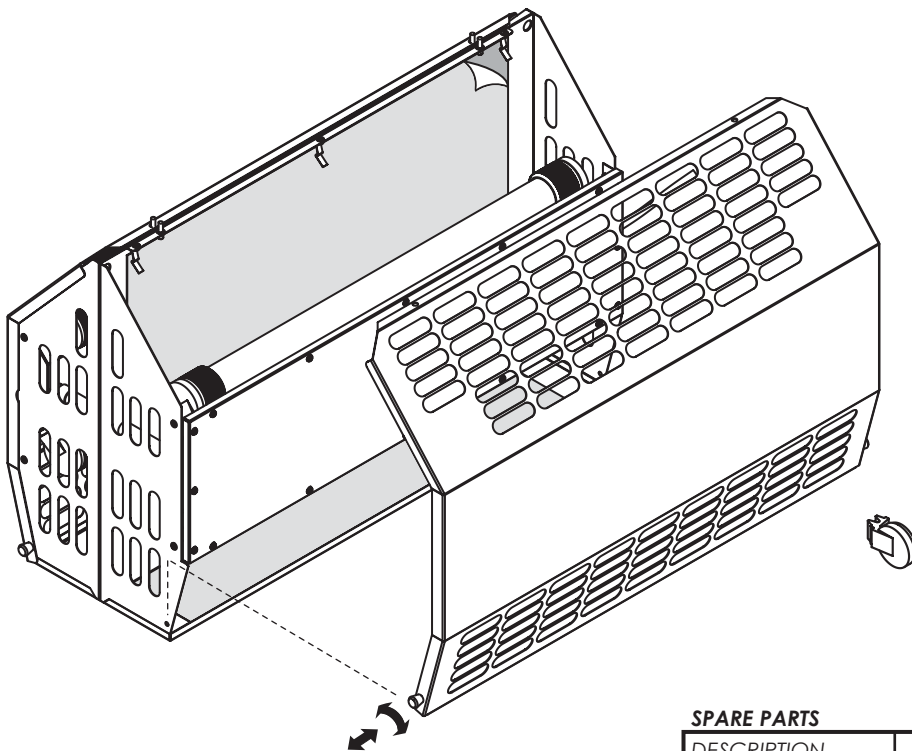
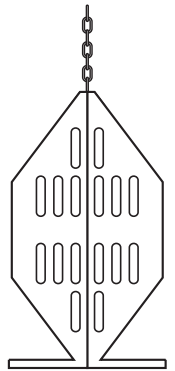

MOUNTING FIXING CENTRES

| DESCRIPTION | DISTANCE |
|-------------|----------|
| WALL | 450mm |
| SUSPENDED | 665mm |

SPARE PARTS

| DESCRIPTION | ZF008/EX | ZF009/EX |
|-----------------|------------|------------|
| TUBES | 2 x I618SP | 4 x I618SP |
| GLUEBOARDS (X6) | INF062 | INF062 |