

Flytrap Professional

Professional Glueboard Insect Control

Please read these instructions carefully and store in a safe place for future reference.

FLYTRAP PROFESSIONAL

As part of the P+L brand of insect control products, **Flytrap Professional** is an effective and versatile professional flykiller which utilises highly effective UV tubes and is designed for use with a high specification glupac™ glueboard. Three sizes of unit are available, all of which can be white coated mild steel or high grade stainless steel. **Flytrap Professional** can be mounted by seven different methods, making it the most flexible professional flykiller on the market.

Contents of package

- 1 x Flytrap Professional flykiller
- 1 x glupac™ pheromone impregnated glueboard
- 1 x Mounting options sheet
- 2 x Screws wall plugs and suspension keyrings
- 1 x Mains cable
- 2 x High powered UV tubes (Fitted)

WARNING - THIS APPLIANCE MUST BE EARTHED

INSECT CONTROL PRODUCTS

Flytrap Professional utilises high powered ultra violet tubes to attract flying insects and retains the caught insects on a pheromone impregnated glueboard for inspection or hygienic disposal.

POSITIONING

THIS UNIT IS FOR INDOOR USE ONLY.

Flytrap Professional should ideally be fixed around two meters above the ground, preferably in the darkest place within the area to be protected and is supplied with a two meter mains lead. Do not position the unit close to windows, skylights or other sources of light, or where it may be obscured by furniture, doors or other obstacles. Ideally, **Flytrap Professional** unit should be visible from every part of the area to be protected.

INSTALLATION

PRIOR TO INSTALLATION, ENSURE THE POWER SUPPLY OF YOUR MAINS OUTLET CORRESPONDS TO THAT MARKED ON THE SPECIFICATION LABEL FOUND ON THE FLYKILLER.

Flytrap Professional can be mounted in seven different ways as shown in the separate mounting options document. Once installed in position, fit the glupac™ glueboard in position as described in the glueboard replacement section of this document. Use the removable mains lead and plug to connect the **Flytrap Professional** to an appropriate power supply.

WARNING - THIS APPLIANCE MUST BE EARTHED

USING FLYTRAP PROFESSIONAL

Flytrap Professional should ideally be in operation for 24 hours a day, ensuring your premises are kept free of flying insects. Insects are most attracted to **Flytrap Professional** unit at night when there is no competition from daylight or other light sources.

CLEANING

ENSURE THAT THE FLYING INSECT KILLER IS DISCONNECTED FROM THE MAINS BEFORE CLEANING

It is recommended that cleaning is carried out regularly when the glueboard is replaced. Once the glueboard is removed, the unit should be thoroughly wiped down with a damp cloth, removing any build up of dirt. Ensure the unit is completely dry before reconnecting it to the power supply.

GUARANTEE

Flytrap Professional has a three year guarantee and if maintained as recommended in these instructions should continue to work for many years.* Use of non-approved consumables may invalidate the guarantee. Ensure genuine glupac™ glueboards are used in conjunction with this product.

*Excludes tubes, glueboards and starters. Does not cover breakdown due to misuse, incorrect operation or use in an incorrect application.

GLUEBOARD REPLACEMENT

BEFORE REPLACING THE GLUEBOARD, ALWAYS ENSURE THAT THE UNIT IS DISCONNECTED FROM THE MAINS SUPPLY.

The glueboard should be replaced every month with a genuine *glupac*™ glueboard. Use of non-approved glueboards may invalidate your guarantee.

To replace the glueboard...

1. Remove the used *glupac*™ glueboard by simply lifting it clear from the unit and either retain for catch evaluation or dispose of it hygienically.
2. Remove the protective release paper from the new *glupac*™ glueboard.
3. Slowly slide the new *glupac*™ glueboard into position along the two runners with the adhesive side facing the tubes.

Always ensure the selected genuine *glupac*™ glueboards are compatible with your unit, available from your PCO or P+L Systems Ltd.

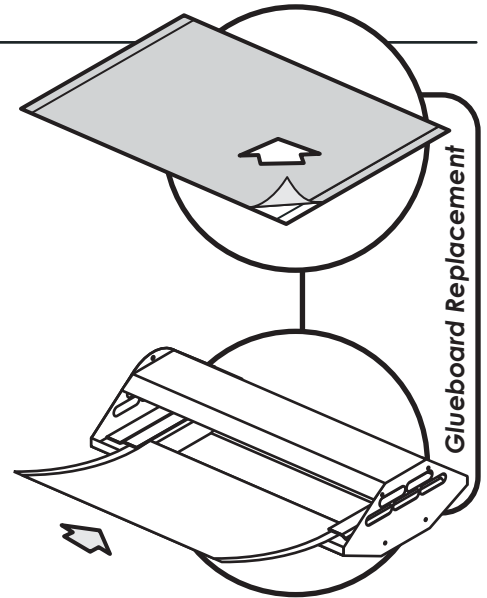

TUBE REPLACEMENT

BEFORE REPLACING THE TUBES, ALWAYS ENSURE THAT THE UNIT IS DISCONNECTED FROM THE MAINS SUPPLY.

To ensure the efficiency of **Flytrap Professional** in catching flying insects, the UV tubes should be replaced annually. After twelve months the phosphor coating that emits the correct wavelength of UV light has burnt away and the UV output is diminished substantially.

To replace the UV tubes...

1. Rotate the tube through 90°, freeing it from the tube holders.
2. Pull the tube away from the chassis.
3. Dispose of the used UV tube in conjunction with local WEEE regulations.

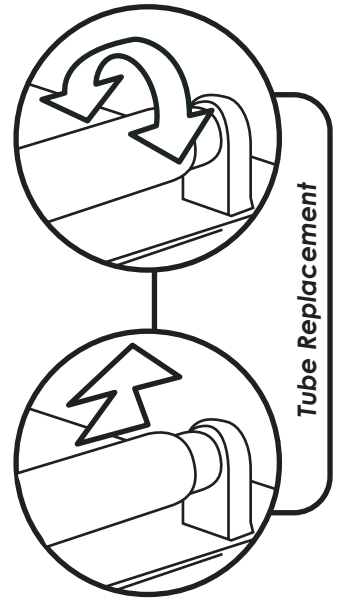

STARTER REPLACEMENT

BEFORE REPLACING THE STARTERS, ALWAYS ENSURE THAT THE UNIT IS DISCONNECTED FROM THE MAINS SUPPLY.

The starters provide an extra spark to initially light the UV tube. Starters wear out and should be replaced at the same intervals as the UV tubes.

To replace the starters...

1. Rotate the starter anti-clockwise.
2. Pull the starter free from the unit.

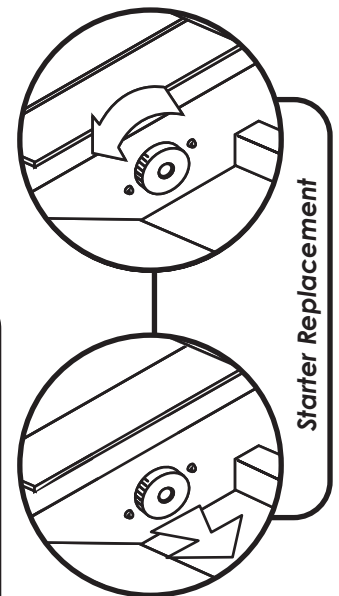

SPECIFICATION / REPLACEMENT PARTS

Unit	FTP30	Unit	FTP40	Unit	FTP80
Voltage	230V ~ 50Hz	Voltage	230V ~ 50Hz	Voltage	230V ~ 50Hz
Dimensions(mm)	470 x 305 x 152	Dimensions(mm)	610 x 305 x 152	Dimensions(mm)	610 x 305 x 152
Coverage	80 Sq. Meters	Coverage	120 Sq. Meters	Coverage	240 Sq. Meters
Weight	4 Kg	Weight	5 Kg	Weight	5 Kg
Light Output	30W	Light Output	40W	Light Output	80W
Tubes	2 x I616	Tubes	2 x I618	Tubes	2 x I662
Starter	2 x I154	Starter	2 x I154	Starter	2 x I154
Glueboards (x6)	INF096	Glueboards (x6)	INF098	Glueboards (x6)	INF098

Flytrap Professional

Professional Glueboard Insect Control

MOUNTING INSTRUCTIONS

