

The P&L brand offers a complete range of insect control products of varying specification and performance. Flyzap™ has been developed as an effective electronic flykiller for use in commercial applications.

FLYING INSECT CONTROL EQUIPMENT

Flyzap™ is the modern answer to commercial insect control for applications where hygiene is an important consideration.

The instructions given here are intended to help you operate Flyzap™ at maximum efficiency. Two sizes of unit are available and both can be ceiling suspended, wall or table mounted.

WARNING

FLYZAP™ MUST ONLY BE USED IN AREAS WHICH ARE FREE OF DUST AND ANY POSSIBLE EXPLOSIVE VAPOUR MIXTURE. SHOULD YOU HAVE ANY QUERIES CONTACT YOUR LOCAL FIRE AUTHORITY FOR ADVICE BEFORE INSTALLATION.

FLYZAP™ IS SUITABLE FOR INDOOR USE ONLY AND IS NOT SUITABLE FOR USE IN BARNs, STABLES AND SIMILAR LOCATIONS.

INSTALLATION

Your Flyzap™ unit requires certain conditions to ensure the effective control of flying insects in your premises:

1. It must be correctly sited.
2. It must be the correct model for the area to be protected.
3. It must be in operation for 24 hours a day.
4. Tubes must be replaced every 12 months.

IF IN ANY DOUBT ABOUT INSTALLATION, USE A QUALIFIED ELECTRICIAN TO FIT THE UNIT.

POWER REQUIREMENTS

Your Flyzap™ unit is designed to operate from the following power supply:

230V AC ~ 50Hz

Therefore, please ensure that your unit is compatible with the electricity supply in your premises. Make sure the unit is connected to an earthed electrical supply via a socket outlet of compatible rating.

WARNING - THIS APPLIANCE MUST BE EARTHED

INSTALLATION

The location for installation requires careful consideration. As a general rule, the UV light from the Flyzap™ unit should be visible from every part of the room and should not compete with natural daylight. Flyzap™ Should ideally be positioned at least two metres from the ground, although applications of Flyzap™ obviously vary depending on the location. Should any queries arise on siting, etc. please contact your supplier.

Flyzap™ can be wall mounted, ceiling suspended or placed on a desktop. To wall mount your Flyzap™, hold the insect catchment tray to the wall and use the two notches as guides for marking and drilling holes. **(As shown over the page.)** Suitable rawl plugs and screws should then be used to secure the unit to the wall

Your Flyzap™ can be ceiling suspended by using the enclosed suspension chain. **(As shown over the page.)**

SERVICING

BEFORE ANY FORM OF SERVICING, ENSURE THAT THE UNIT IS DISCONNECTED FROM THE MAINS SUPPLY.

To maintain the units efficiency, replace the UV fluorescent tubes every 9 - 12 months, making sure the replacement tubes are of the correct type - obtainable from your supplier or the manufacturer.

IF ANY DOUBTS ARISE REGARDING THESE INSTRUCTIONS, PLEASE CONTACT YOUR SUPPLIER OR THE MANUFACTURER.

GUARANTEE

Your Flyzap™ unit comes with a one year guarantee* and if regularly maintained as described in these instructions, should continue to work for many years.

*Excludes tubes and starters. Does not cover breakdown due to misuse, incorrect operation or use in an incorrect application. Any unit failing within the one year period will be exchanged for a replacement unit.

MAINTENANCE

BEFORE ANY FORM OF MAINTENANCE, ALWAYS ENSURE THAT THE UNIT IS DISCONNECTED FROM THE MAINS SUPPLY.

CLEANING

It is recommended that you clean your **Flyzap™** once a month. First remove the catchment tray and hygienically dispose of the caught flying insects. Then thoroughly wipe down the tray and exterior of your **Flyzap™** with a soft damp cloth, removing any build up of dust or dirt.

TUBE REPLACEMENT

To ensure the optimum effectiveness of your **Flyzap™**, the UV tubes should be replaced every 9 - 12 months.

To replace the tubes, unscrew the back guard and swing down, giving access to the two used tubes. Twist the used tube through an angle of 90° as shown in the diagram until it can be pulled free of the tube clips. Reverse the process to fit the new tube.

STARTER REPLACEMENT

The starters should be replaced at the same 9 - 12 month interval as the tubes.

To replace the starters release the used starter by turning anti-clockwise and pulling free. Insert the new starter and turn clockwise until locked in position.

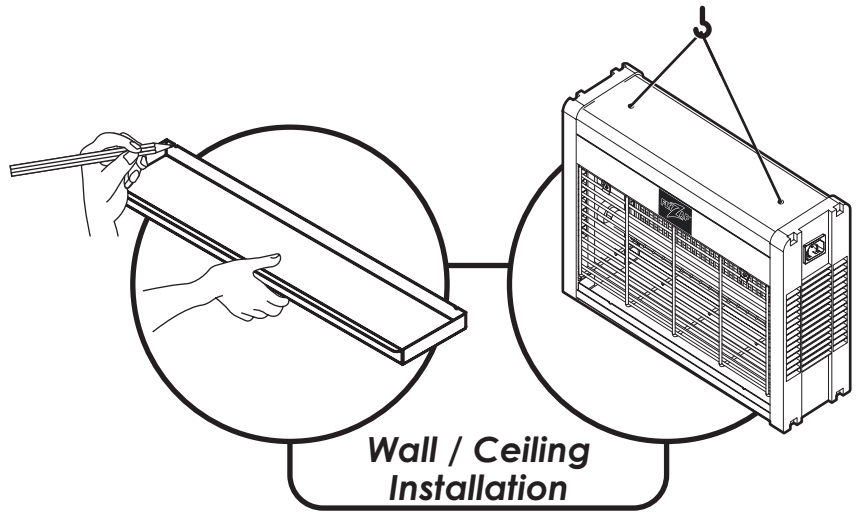

Wall / Ceiling Installation

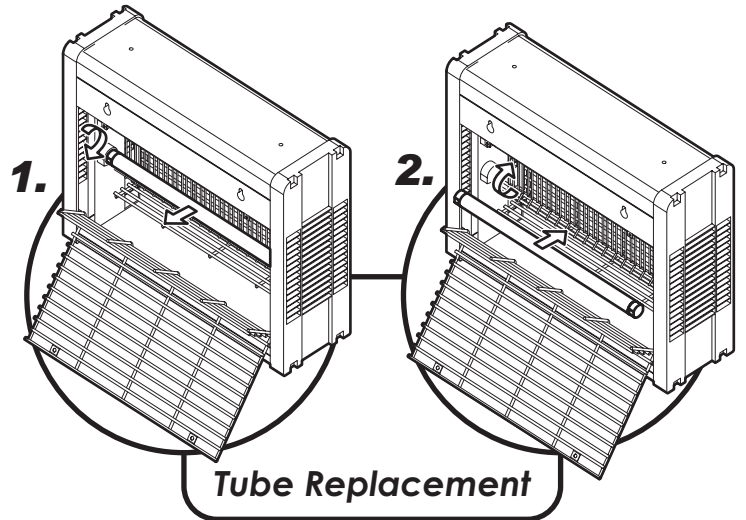

Tube Replacement

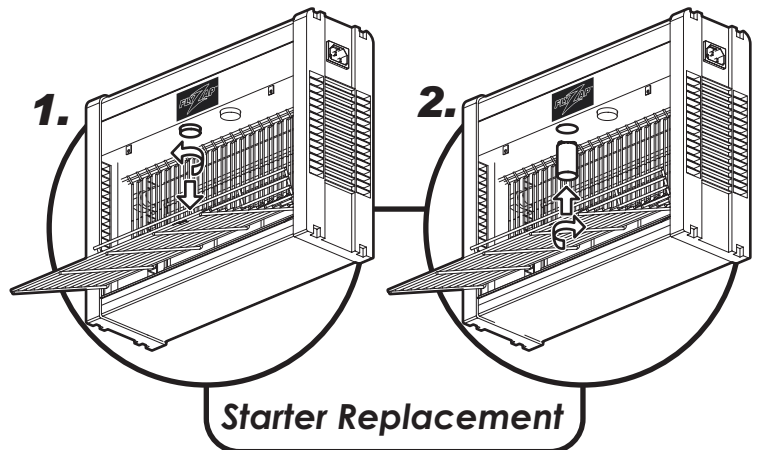

Starter Replacement

SPECIFICATION / REPLACEMENT PARTS

Unit	Flyzap 16
Voltage	230V ~ 50Hz
Dimensions(mm)	350 x 120 x 270
Coverage	40 Sq. Meters
Weight	2.5 Kg
Light Output	16W
 Tubes	2 x I610
 Starter	2 x I154
 Guarantee	1 year

Unit	Flyzap 30
Voltage	230V ~ 50Hz
Dimensions(mm)	500 x 120 x 320
Coverage	80 Sq. Meters
Weight	3.5 Kg
Light Output	30W
 Tubes	2 x I603
 Starter	2 x I154
 Guarantee	1 year

