



Splashproof

SPECIALIST INSECT CONTROL EQUIPMENT

P&L Systems Ltd offer a range of fully serviceable IPX4 Splashproof Insect Control units, all of which incorporate new high powered UV tubes.

INSECT CONTROL EQUIPMENT

Splashproof is the modern answer to flying insect control where hygiene is an important consideration. Two sizes of unit are available and all can be wall mounted, ceiling suspended or surface mounted.

The instructions given here are intended to help you operate the **Splashproof** equipment at maximum efficiency.

WARNING

SPLASHPROOF MUST ONLY BE USED IN AREAS WHICH ARE FREE OF ANY POSSIBLE EXPLOSIVE VAPOUR MIXTURE. P&L CAN NOT BE HELD RESPONSIBLE FOR THE USE OF THIS EQUIPMENT IN SPECIFIC APPLICATIONS. SHOULD YOU HAVE ANY QUERIES CONTACT YOUR LOCAL FIRE AUTHORITY FOR ADVICE BEFORE INSTALLATION.

INSTALLATION

Your **Splashproof** unit requires certain conditions to ensure the effective control of flying insects in you premises:

1. It must be correctly sited.
2. It must be the correct model for the area to be protected.
3. It must be in operation for 24 hours a day.
4. Tubes must be replaced every 12 months.

IF IN ANY DOUBT ABOUT INSTALLATION, USE A QUALIFIED ELECTRICIAN TO FIT THE UNIT.

POWER REQUIREMENTS

Splashproof units are designed to operate from the following power supply:

230V ~ 50Hz

Therefore please ensure that your unit is compatible with the electricity supply in your premises. Make sure the unit is connected to an earthed electrical supply via a socket outlet of compatible rating.

POSITIONING

Your **Splashproof** unit should ideally be fixed at least two metres above the ground, preferably in the darkest place within the area to be protected. **Splashproof** should be installed away from windows, skylights or any other sources of sunlight, which would cause competition in attracting flying insects.

In large open areas where two or more units are required, siting needs careful consideration to ensure maximum protection. As a general rule, multiple installations of **Splashproof** should be positioned in opposite corners of the application to be protected.

SERVICING

BEFORE ANY FORM OF SERVICING, ENSURE THAT THE UNIT IS DISCONNECTED FROM THE MAINS SUPPLY.

To maintain the units efficiency, replace the UV fluorescent tubes every 9 to 12 months, making sure the replacement tubes are of the correct type - obtainable from the supplier or P&L Systems Ltd.

Details of how to service **Splashproof** are found on the reverse of this installation sheet.

IF ANY DOUBTS ARISE REGARDING THESE INSTRUCTIONS, PLEASE CONTACT YOUR SUPPLIER OR P&L SYSTEMS LTD.

GUARANTEE

Your **Splashproof** unit has a three year guarantee* (excluding tubes.) If a fault occurs within twelve months P&L Systems Ltd will replace your unit. If a fault occurs between 12 and 36 months, P&L Systems Ltd will either replace or repair the unit, at their discretion, provided the unit is returned.

This guarantee only applies if genuine P&L Systems Ltd spare parts are used.

*Excludes tubes, ballasts and starters. Does not cover breakdown due to misuse, incorrect operation or use in an incorrect application.

MAINTENANCE - BEFORE ANY FORM OF MAINTENANCE ENSURE THAT THE UNIT IS DISCONNECTED FROM THE MAINS SUPPLY.

CLEANING - BEFORE ANY FORM OF CLEANING ENSURE THAT THE UNIT IS DISCONNECTED FROM THE MAINS SUPPLY.

TUBE REPLACEMENT

Remove the tray and killing grid. Unscrew the tube connector sealing rings, then rotate the tube until free and remove it. Replace the tube in the reverse order, ensuring that all the tube sealing gaskets are fitted correctly.

STARTER REPLACEMENT

The starters are positioned in the inside top of the unit, behind the sealed caps. First remove the caps by unscrewing anti-clockwise. (1.1) Then rotate the starter anti clockwise and pull free from the unit. (1.2) Position the new starter in place by repeating the above process in the reverse order, ensuring the sealed cap is screwed firmly in place.

First remove the tray and dispose of the insect bodies. The exterior of the unit should be cleaned with a damp cloth, removing the normal dirt and grease found in most operating conditions. All metal used in the construction is high quality stainless steel and therefore should remain in good condition for many years.

From time to time you may wish to clean the killing grid. Disconnect the killing grid by first pushing the killing grid up (2.1) then pulling downwards (2.2).

To replace, simply carry out the above procedure in reverse, being careful to locate the killing grid in the sockets correctly.

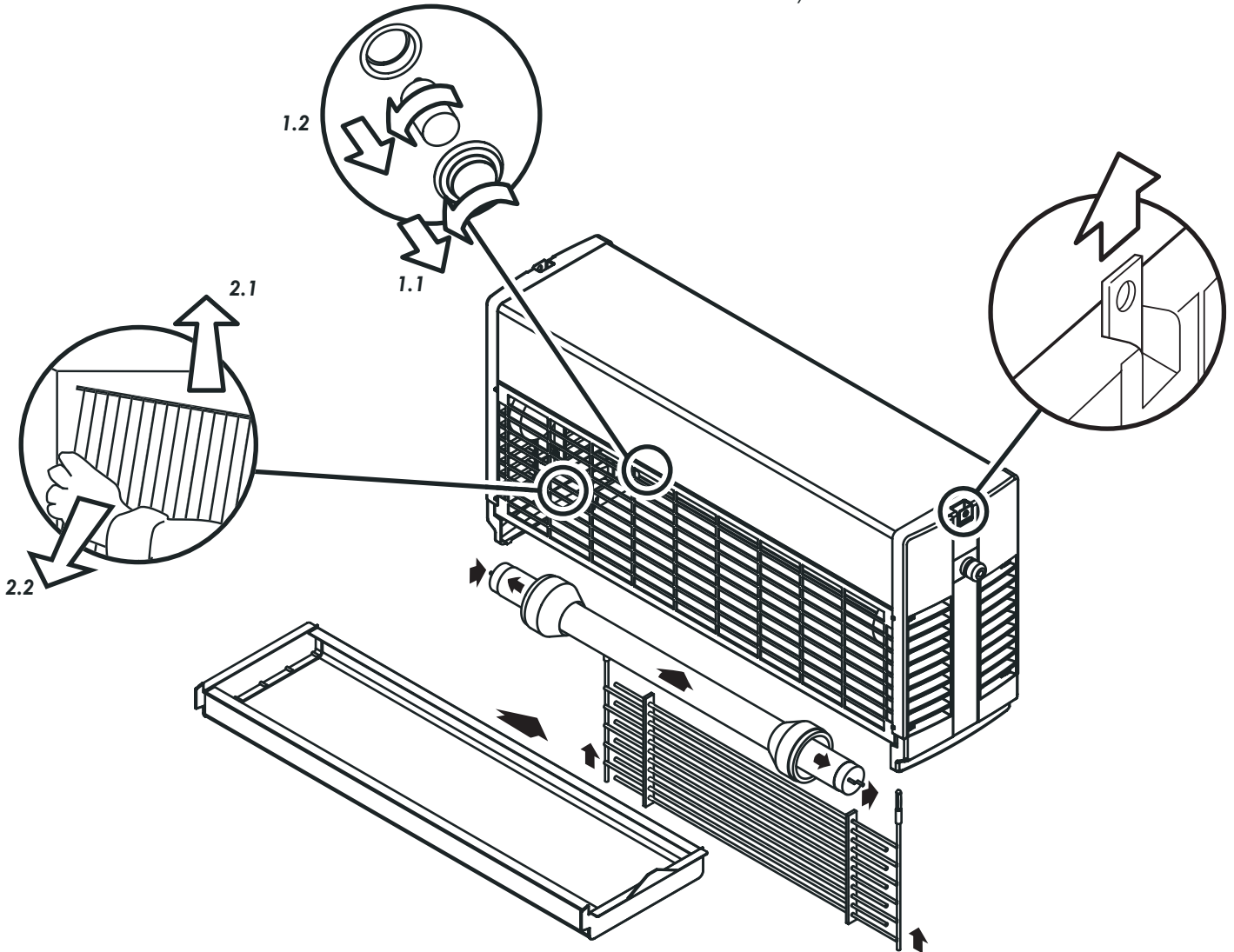

MOUNTING FIXING CENTRES

DESCRIPTION	SP30	SP80
CEILING SUSPENSION	556mm	721mm
WALL MOUNTED	476mm	549mm

SPARE PARTS

DESCRIPTION	SP30	SP80
TUBES	2 x I616SP	2 x I662SP
STARTERS	2 x I154	2 x I154

Brighter Hygiene Solutions...

P&L SYSTEMS LTD
 19 Halfpenny Lane
 Knaresborough
 North Yorkshire
 HG5 0PS
 UK

T - +44 (0)1423 861226
 F - +44 (0)1423 863497
 E - info@pandl.co.uk
 W - www.pandlsystems.com



INVESTOR IN PEOPLE

